

Revision	Description	Ordinance	Date
1	Smith Implements	2013-8	9/25/2013
2	Prairie Trails	2014-10	8/27/2014
3	Covance	2014-13	12/11/2014
4	Brunson Village lot 22	2015-10	9/14/2015
5	Hill Grove	2015-5	9/23/2015
6	Melton	2016-6	5/11/2016
7	Olthof	2021-1	2/10/2021
8	Johnson Annexation	2021-13	7/14/2021
9	The Forest	2021-26	11/24/2021
10	Thornwood	2022-06	3/4/2022
11	Hunter and Community Foundation	2023-27	10/11/2023

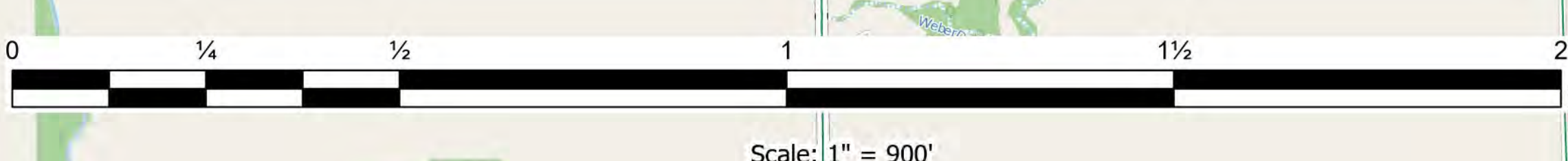

Map data © OpenStreetMap contributors, Mapbox, and its affiliates, Esri Community Maps contributors, Mapbox, and its affiliates.
 Path: X:\Private\Boundaries\maps\annexation\AnnexationWorkspace\AnnexationWorkspace.aprx

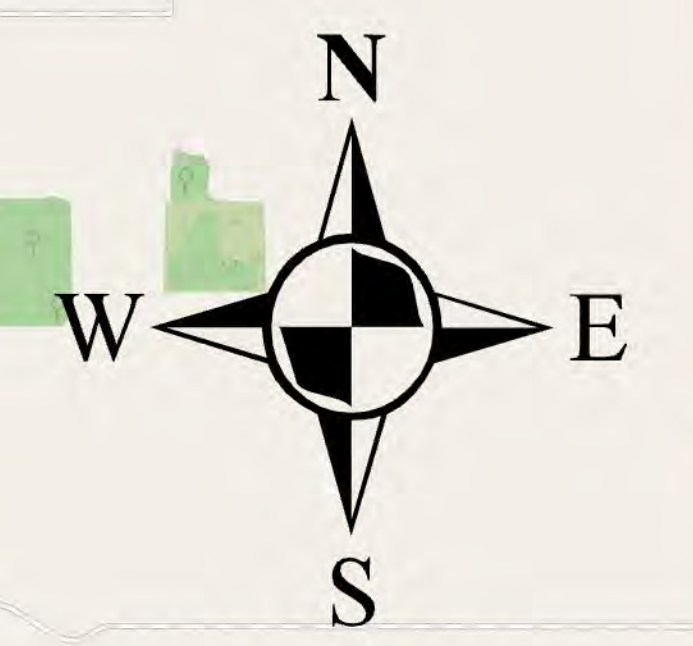

OFFICIAL ANNEXATION MAP
 Date Saved: 11/17/2023 2:45 PM

ANNEXATIONS							
Index, ordinance, alias	28, By Plat, JOHN J CARRINGERS	56, 1953-19, MAPLELAWN	84, 1967-17, FRANKLIN STREET	112, 1974-4, PARK & PRATT	140, 1992-13 1992-16, ST. JAMES	168, 2004-11, KEYSTONE	
1, 1839-1, ORIGINAL GREENFIELD	29, By Plat, MASONS ADDITION	57, 1954-00, WESTON VILLAGE PLAT	85, 1967-22, GCHS	113, 1976-15, 1247 N. STATE STREET	141, 1993-4, APPLEVIEW	169, 2004-31, TOLLEFSON	
2, 1839-2, FIRST SOUTH ADDITION	30, Undocumented, UNDOCUMENTED	58, 1967-25, MCKENZIE ROAD	86, 1967-25, MCKENZIE ROAD	114, 1976-22, MILLER'S & KFC	142, 1993-10, FLEMING	170, 2004-33, SPRINGHURST WEST	
3, By Plat, PEIRSON'S FIRST ADDITION	31, By Plat, BEECHERS ADDITION	59, By Plat, BOYD ACRES ADDITION	87, 1968-2, MEDICAL CENTER	115, 1977-7, CIP	143, 1993-10, CHAPMAN/DAVIS RD/STATE ST	171, 2005-2, TOLLEFSON	
4, By Plat, MEEK & HARTS ADDITION	32, By Plat, RANDALL PLACE	60, 1955-15, FAIRVIEW	88, 1968-9, RILEY TRAILER PARK	116, 1977-17, LIBERTY SHORES	144, 1994-2, SUMMERS MCKENZIE GLEN	172, 2005-4, BRANDYWINE FARMS	
5, By Plat, PEIRSON'S SECOND ADDITION	33, By Plat, ROSE HILL SUBDIVISION	61, By Plat, WHITAKERS	89, 1968-13, LUTHERAN CHURCH PROPERTY	117, 1978-8, 601 N. CHERRY	145, 1995-12, WHITCOMB VILLAGE	173, 2005-16, JIM WELDFIELDS	
6, By Plat, JUNCTION RAILROAD ADDITION	34, By Plat, EAGANS ADDITION	62, 1956-14, HANNA HOME	90, 1969-7, WATERVIEW	118, 1979-4, BIG LOTS	146, 1997-7, COLCLAZIER PROPERTY	174, 2006-6, RIDGES OVER BRANDYWINE	
7, By Plat, BRADLEYS ADDITION	35, By Plat, OLDHAMS ADDITION	63, 1956-16, LAYNECREST	91, 1969-8, SHERWOOD HILLS	119, 1980-5, 7TH & BROADWAY NW	147, 1997-18, GREENFIELD BOX	175, 2007-1, CENTRAL INDIANA POWER	
8, By Plat, ELDERS ADDITION	36, By Plat, SNOWS HIGHWAY ADDITION	64, 1957-21, MCKENZIE & EIKENBERRY	92, 1969-13, SOUTH OF MCDONALDS	120, By Plat, OAK COURT ADDITION	148, By Plat, SOUTH COMMONS	176, 2007-7, 911 CENTER	
9, By Plat, SNOW'S ADDITION AND RESERVE	37, 1936-19, CHANDLERS ADDITION	65, 1957-7, KNITWEAR	93, 1969-17, WINFIELD PARK EAST	121, 1981-1, 1500 N. APPLE	149, 1999-02, EAGLESTON PART A	177, 2008-11, EAGLESTON MILLER WINTER PARK	
10, By Plat, TEALS ADDITION	38, 1948-16, MEADOWBROOK	66, 1957-6, HOSPITAL	94, 1970-6, NURSING HOME ON SWOPE	122, 1981-15, 1521 N. APPLE	150, By Plat, WRIGHTS ADDITION	178, 2008-18, BARR - LARK	
11, By Plat, STUARTS	39, 1948-17, 7TH & BROADWAY NE	67, 1957-18, TAGUE & NOBLE	95, 1970-4, GREENBROOK PLUS	123, 1984-1, LUTES GREEN MEADOWS	151, 1999-10, CASEYS GENERAL STORE	179, 2009-2, FROST 40 ACRES	
12, By Plat, BURDETTS	40, 1950-7, MAPLELAWN	68, 1957-29, RILEY PARK TIRE (BURMA)	96, 1970-12, REPLACED BY 1970-40	124, 1984-23, LUTHERAN SOCIAL SERVICES	152, 2000-1, J.B. STEPHENS	180, 2009-23, LOT 3 JOHNSON FAM MS	
13, By Plat, PATRICK AND JAMES O'DONNELL'S ADDITION	41, 1951-1, 4TH & BROADWAY SE	69, 1958-12, CEMETERY PROPERTY	97, 1970-16, CANDELITE NORTH	125, 1985-03, IPT	153, By Plat, SHARES BUSINESS PARK	181, 2010-6, JOHNSON 10 AC	
14, By Plat, WOODS ADDITION	42, 1951-6, MAIN & JEFFERSON	70, 1959-25, LAYNECREST	98, 1970-36, NORTH SWOPE STREET	126, 1985-11, NEW KROGER - PONDEROSA	154, 2000-21, COPELAND FARMS	182, 2011-2, FROST PROPERTY	
15, By Plat, CHANDLERS OLD ADDITION	43, 1951-5, WESTON VILLAGE	71, 1961-1, ROLL COATER	99, 1970-40, SEE 1971-9	127, 1985-27, WILSON TRACTS 170/SR9	155, 2001-16, STICKS AND STONES	183, 2013-8, SMITH IMPLEMENTS	
16, By Plat, BURDETTS 2ND ADDITION	44, 1951-11, EAST MAIN STREET	72, 1961-27, OLD STREET BARN	100, 1971-3, CANDELITE AND FAITH LUTHERAN	128, 1985-30, SR9 - NEW ROAD - MERIDIAN	156, 2002-1, EASTGATE/HOLTZCLAW	184, 2014-10, PRAIRIE TRAILS SEGO DISMORE	
17, By Plat, WALKERS ADDITION	45, 1951-10, 800 SOUTH STATE STREET	73, 1963-28, COVANCE	101, 1971-7, ELKS	129, 1986-13, NORTH STATE VARIOUS	157, 2002-8, SPRINGHURST	185, 2014-13, COVANCE	
18, By Plat, BOARD OF TRADE ADDITION	46, 1952-7, HOLIDAY PARK2	74, 1963-29, RAILROAD PROPERTY AT COVANCE	102, 1971-9, NE APPLE AND MCKENZIE	130, 1987-04, POPE WAREHOUSE	158, 2002-11, OAK HIGHLANDS	186, 2015-12, BRUNSON VILLAGE LOT 22	
19, By Plat, EXCHANGE ADDITION	47, 1952-8, STEVENS PARK FRONT ADDN.	75, 1963-27, COVANCE	103, 1971-11, ELKS	131, 1987-6, BRANDYWINE PARK	159, 2002-13, INDIGO	187, 2015-5, HILL GROVE ADDITION	
20, By Plat, BOYDS HIGHLAND HOME	48, By Plat, ROOSEVELT ADDITION	76, 1965-11, MAIN STREET	104, By Plat, CENTRAL HIGH ADDITION	132, 1987-10, NORTH BROADWAY	160, 2002-24, SAWMILL PART A	188, 2016-6, MELTON	
21, By Plat, PEIRSON'S THIRD ADDITION	49, By Plat, CENTRAL ADD TO GREENFIELD	77, 1965-21, RIGHT-OF-WAYS	105, 1972-4, CANDELITE AND FAITH LUTHERAN	133, 1988-31, NORTH SUBSTATION	161, 2003-4, SAWMILL PART B	189, 2021-18, FRALICH FAMILY TRUST	
22, By Plat, THAYERS PARK FRONT ADDITION	50, 1952-12, MAPLELAWN	78, 1965-29, LEARYS AND MCCULLEYS	106, 1972-15, 7TH & BROADWAY NW	134, 1987-18, FAIRGROUNDS	162, 2003-14, SOUDER/WEISS	190, 2021-1, OLTHOF	
23, By Plat, WILLIAM NEWS ADDITION	51, By Plat, EAGLESTONS SUBDIVISION	79, 1966-31, LILLY	107, 1972-18, BOWMAN ACRES	135, 1988-15, BRANDYWINE HALL	163, 2004-1, SPRINGHURST	191, 2021-13, JOHNSON ANNEXATION	
24, By Plat, WILLIAM P WILSONS ADDITION	52, 1953-12, PARK AND WILSON	80, 1966-32, GREENMEADOWS	108, 1973-4, AUTOMOBILE ROW	136, 1989-08, ROLL COATER	164, 2004-3, LIBRARY	192, 2021-26, THE FOREST	
25, By Plat, ARTHUR P WILLIAMS ADDITION	53, By Plat, PARK AVENUE SECOND ADDITION	81, 1967-7, BIG BLUE	109, 1973-12, STATE STREET LICQUOR	137, 1989-24, WHITCOMB MEADOWS	165, 2004-10, LIBRARY	193, 2022-06, THORNWOOD	
26, By Plat, DUNNS ADDITION	54, 1953-18, ST. MICHAELS	82, 1967-18, MARY MOORE PARK	110, 1973-15, WALNUT WOODS	138, 1989-20, AVERY DENNISON	166, 2004-14, WEBB	194, 2023-27, HUNTER AND COMMUNITY FOUNDATION	
27, By Plat, F G BANKERS ADDITION	55, 1953-26, NW CORNER STATE AND MCKNZ	83, 1967-21, CHAPMAN ESTATES	111, 1974-3, FRANKLIN PLACE	139, By Plat, FOREST GLEN	167, 2004-17, BECKENHOLDT	<all other values>	